

LOCK SWITCH

SRLMC MAINS LOCK SWITCH - COMPACT Switch module approved to ENEC61058

ELECTRICAL & MECHANICAL SPECIFICATION

Switch Rating:	4/80A @240V ac R.C.	Life:	>15,000 Cycles
Proof Voltage:	3Kv min (Initial)	Operating Temperature:	-25°C to +85°C
Insulation Resistance:	>999MΩ @ 500V dc (Initial)	Flame Retardancy:	UL94V0
Contact Resistance:	<20mΩ (Initial)	Lock Type:	5 Disc
Contact Material:	Brass CZ108, Ag Plat	Lock Housing:	Zinc Alloy Bright Cr Plated
Switch Contact Material:	Silver Cadmium Oxide	Switch Chamber:	Polyamide 6.6 G>F. V0 Rated
		Housing Material:	Polycarbonate
		Tag Panel:	SRBP

FEATURES

- Double pole mains isolating – ENEC 2 keys per switch - Up to 200 differ key combinations available
- Length behind panel <30mm Keys are double entry (can be inserted into lock either way up)
- max panel thickness 4.5mm 60 ° lock movement

- Solder or PCB terminals
- Parallel or tapered lock heads
- Two stage assembly: Lock through front, module snaps on from inside
- Made in the UK

PANEL PIERCING DETAILS

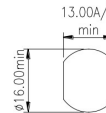

Parallel bezel

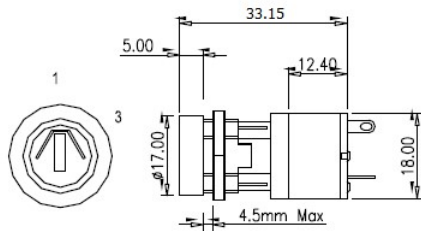

Tapered bezel

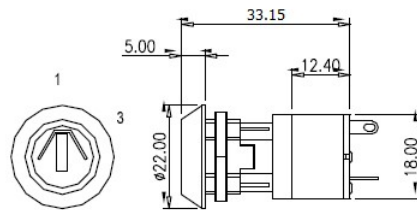

ORDERING CODE

CIRCUITRY	TERMINAL LAYOUT VIEWED FROM REAR OF SWITCH	KEY WITHDRAWAL POSITIONS
2 POLE OFF-ON		60°
2 POLE ON-OFF (NORMALLY CLOSED)		

SWITCH	KEY	POSITION IN WHICH KEY FREE	Tapered lock Head Order-codes	Parallel lock Head Order-codes
2 POLE OFF – ON	DIFFERS	0° and 60° (1+3)	SRLMC -5-Q-D	SRLMC -5-U-D
	DIFFERS	0° only (1)	SRLMC -5-S-D	SRLMC -5-W-D
2 POLE OFF –ON	SAME	0° and 60° (1+3)	SRLMC -5-Q-S	SRLMC -5-U-S
	SAME	0° only (1)	SRLMC -5-S-S	SRLMC -5-W-S
2 POLE ON-OFF	DIFFERS	0° and 60° (1+3)	SRLMC -5-R-D	SRLMC -5-V-D
	DIFFERS	0° only (1)	SRLMC -5-T-D	SRLMC -5-X-D
2 POLE ON-OFF	SAME	0° and 60° (1+3)	SRLMC -5-R-S	SRLMC -5-V-S
	SAME	0° only (1)	SRLMC -5-T-S	SRLMC -5-X-S

